



Survey Report: No. 4
Photographic Survey of
Farmhouse and outbuildings at
Dunanney, Carnmoney,
County Antrim.



Initial photographic survey undertaken 8.4.2014 by Lizzy Pinkerton, Geoff Wright, Karen Foreman and Michael Catney. While stage 2 survey undertaken 18.8.2015 by Lizzy Pinkerton, Karen Foreman, Michael Catney, Amanda Girvan, Jim McAllister and Lesley McKay.

The farmhouse complex is found on the slopes of Carnmoney Hill (IGR J33616 82432), Dunnaney townland, part of the Belfast Hills which is owned by Newtownabbey Borough Council and managed by the Woodland Trust.

The buildings that are visible today are shown on the 1st Edition OS map of 1833. The Griffith Valuation of 1862 lists John Thompson as the occupier of the farmhouse. The Thompson Family continued to live in the farmhouse up until the 1960's with Aggie Thompson being the last occupier of the house before it was destroyed in a fire.

On the 1901 census the house is described as a 2nd class house with three windows in the front of the house and six rooms occupied. The census also notes nine outbuildings, a stable, harness room, cow house, piggery, fowl house, boiling house, barn, turf house and shed.

Early 2015 the site was cleared and conserved as it provides an insight into rural farming life in the 19th and 20th century. A stone masonry company called 'The Art of Stone', accredited Heritage contractors, undertook the work using traditional lime mortar as part of the Belfast Hills Partnership Landscape Partnership Scheme funded by the Heritage Lottery Fund.



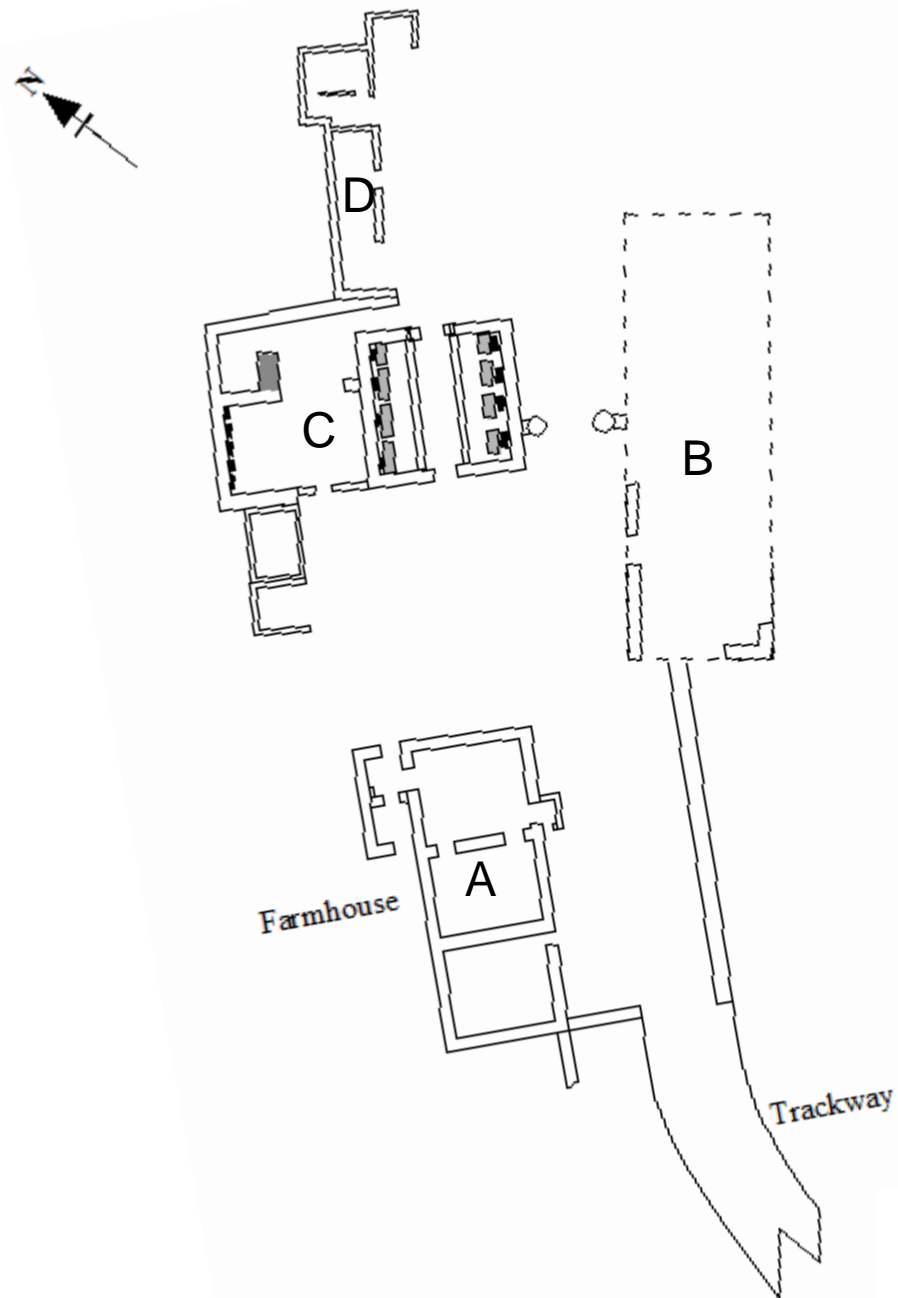

Dunannee Farm
complex wall footings
plan
A = Farm House
B, C & D = Out
buildings

Chronology of farmyard complex

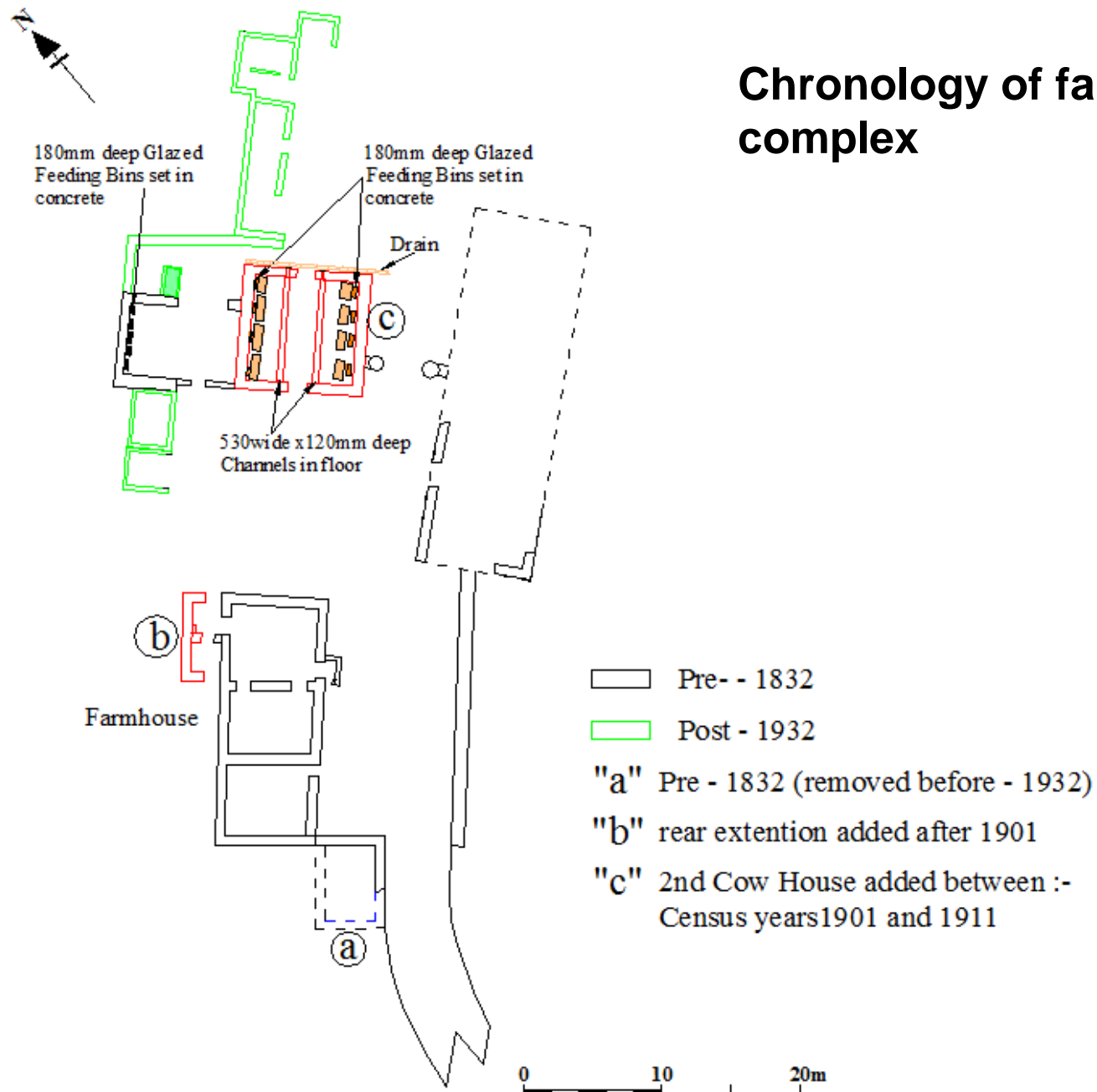

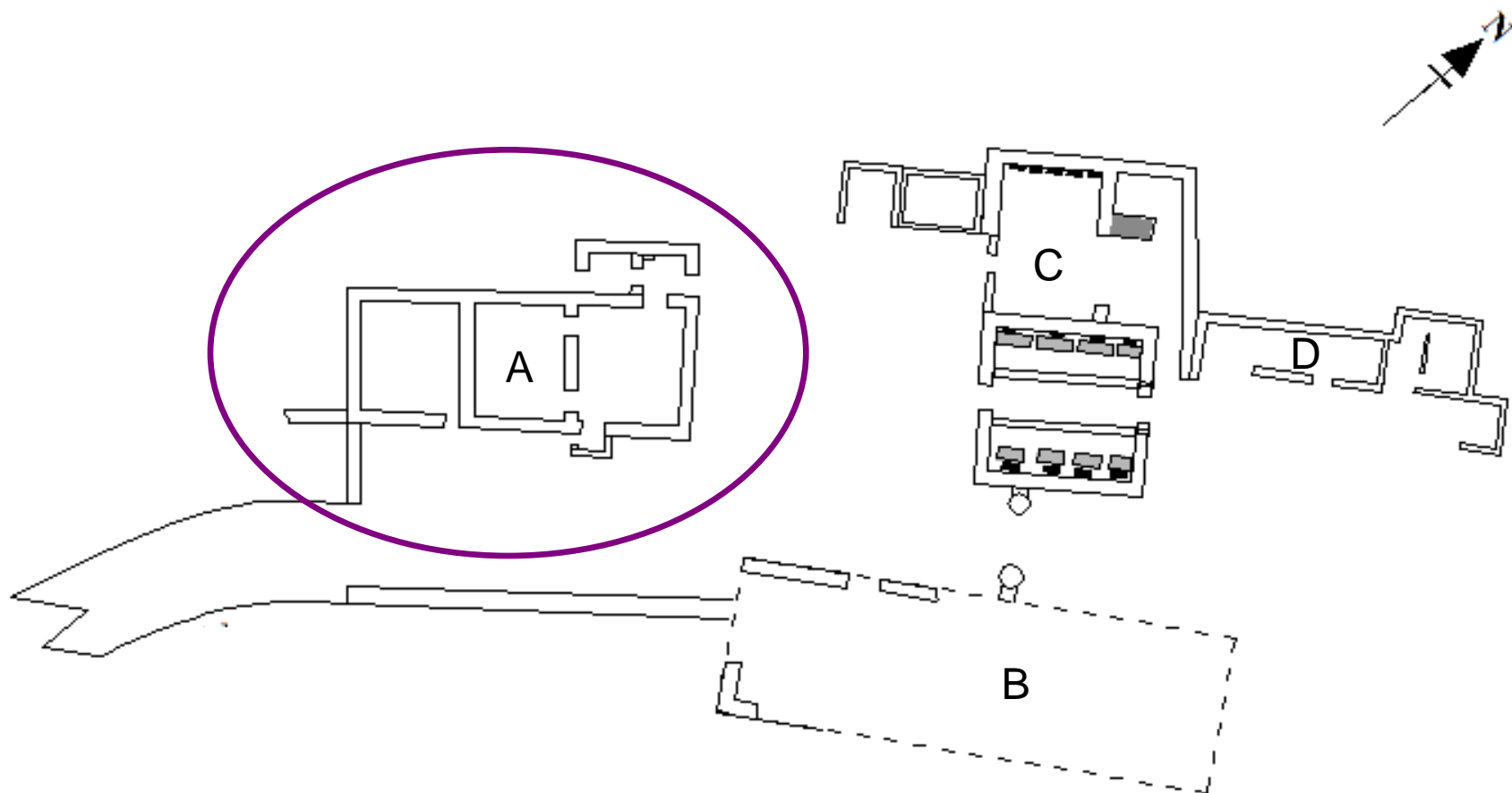



Photographs of
external walls pre
conservation

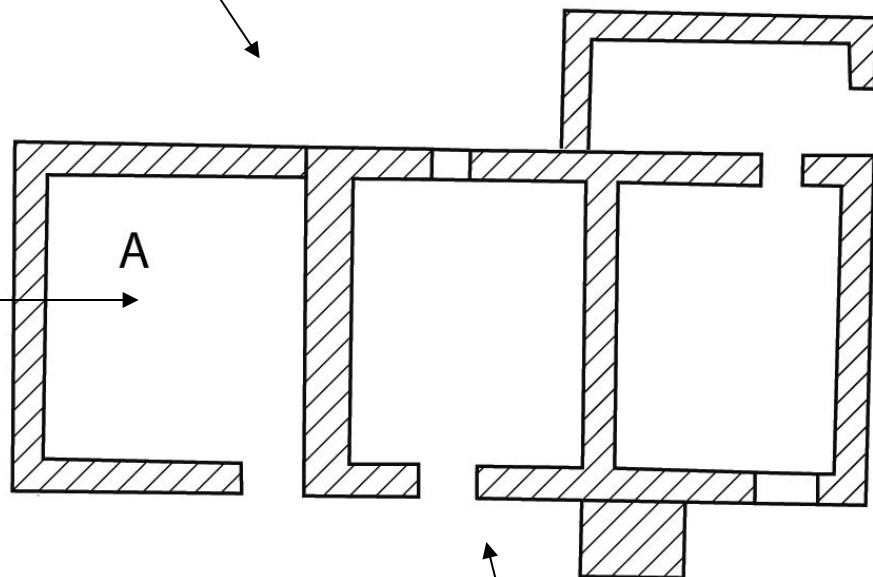



Photographs of external walls post conservation

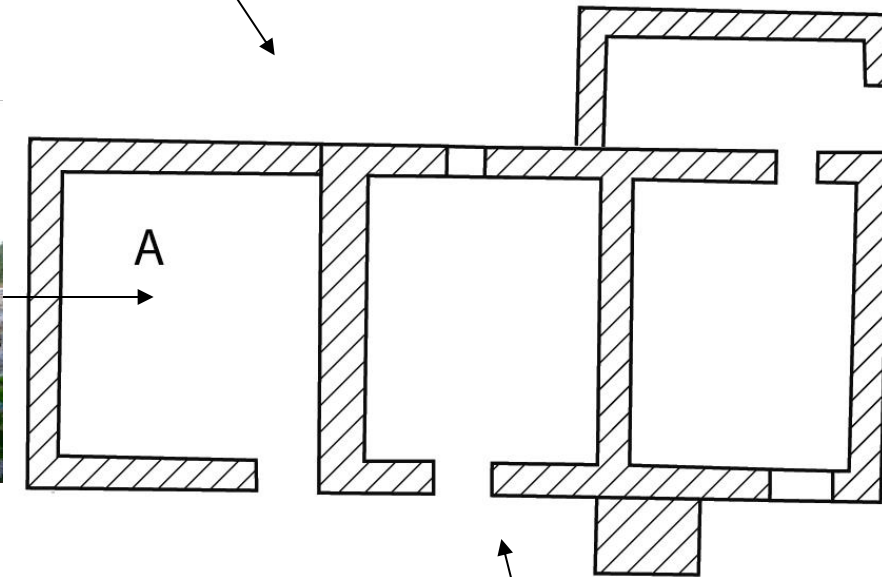

Photographs of internal walls pre conservation



A



Photographs of internal walls post conservation



A

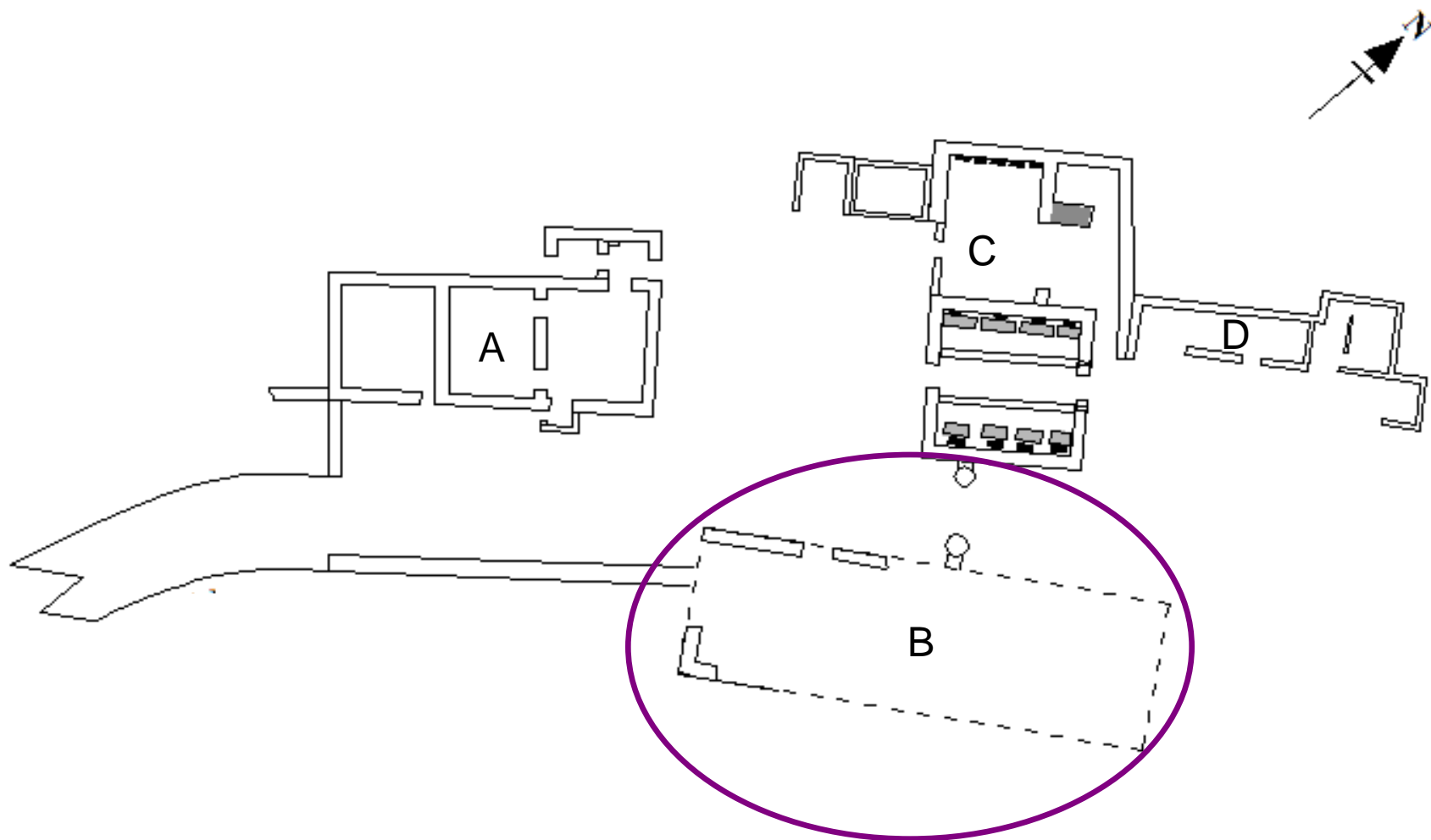

Photographs of
internal and
external walls pre
conservation

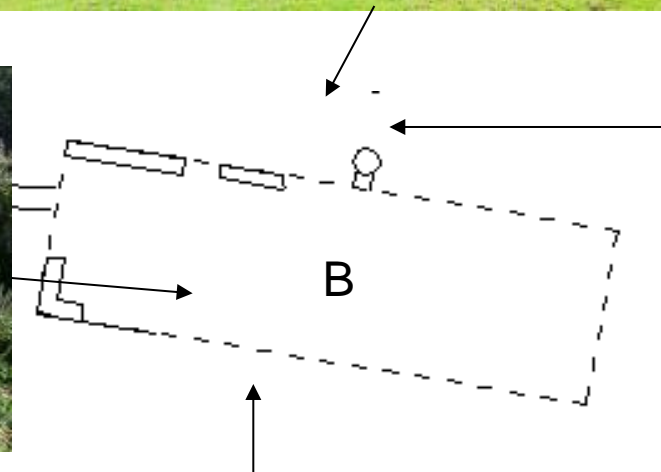

Photographs of
internal and
external walls
post conservation

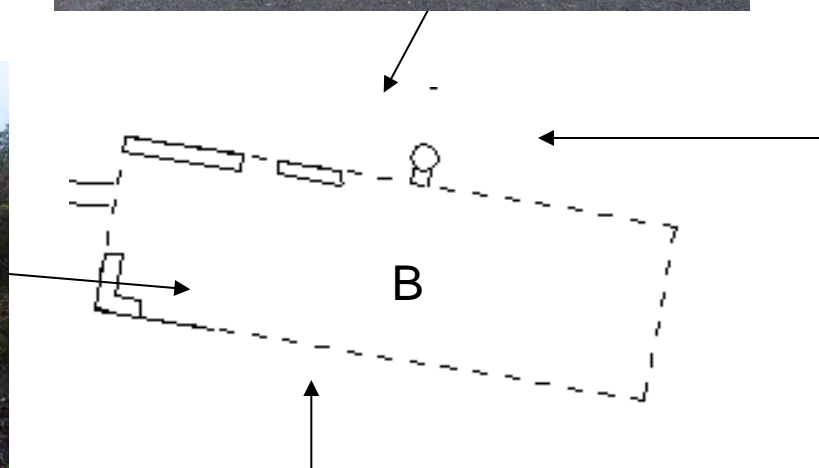

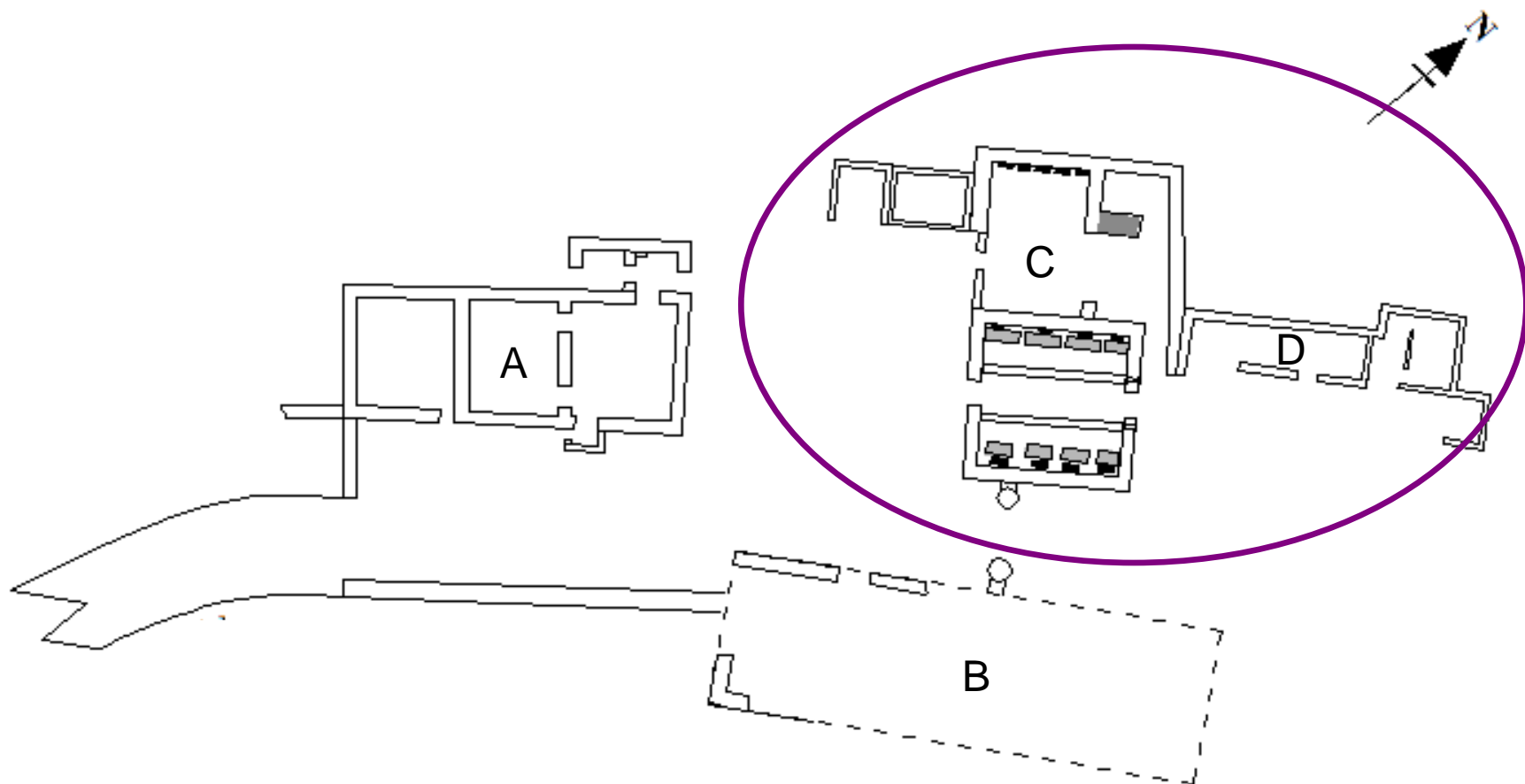

Photographs of
external walls pre
conservation



Photographs of
external walls
post conservation

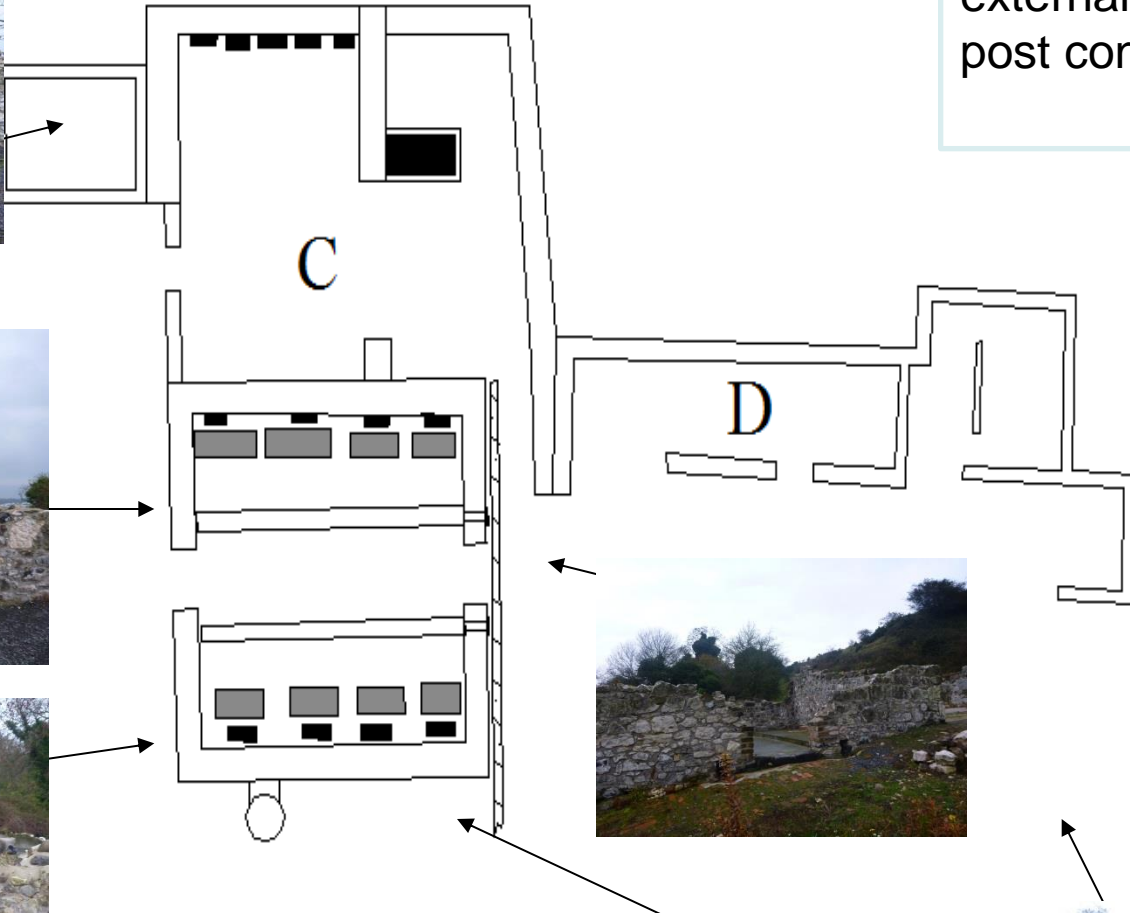

Photographs of
internal walls pre
conservation

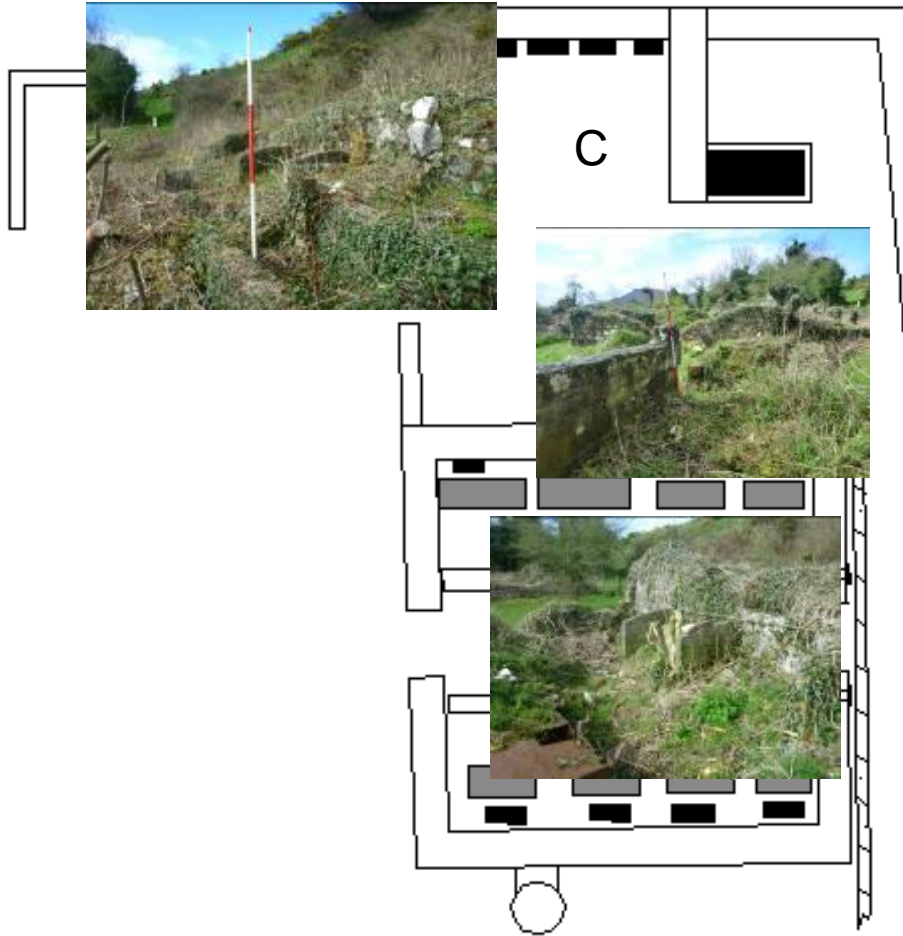

D



Photographs of
internal walls post
conservation

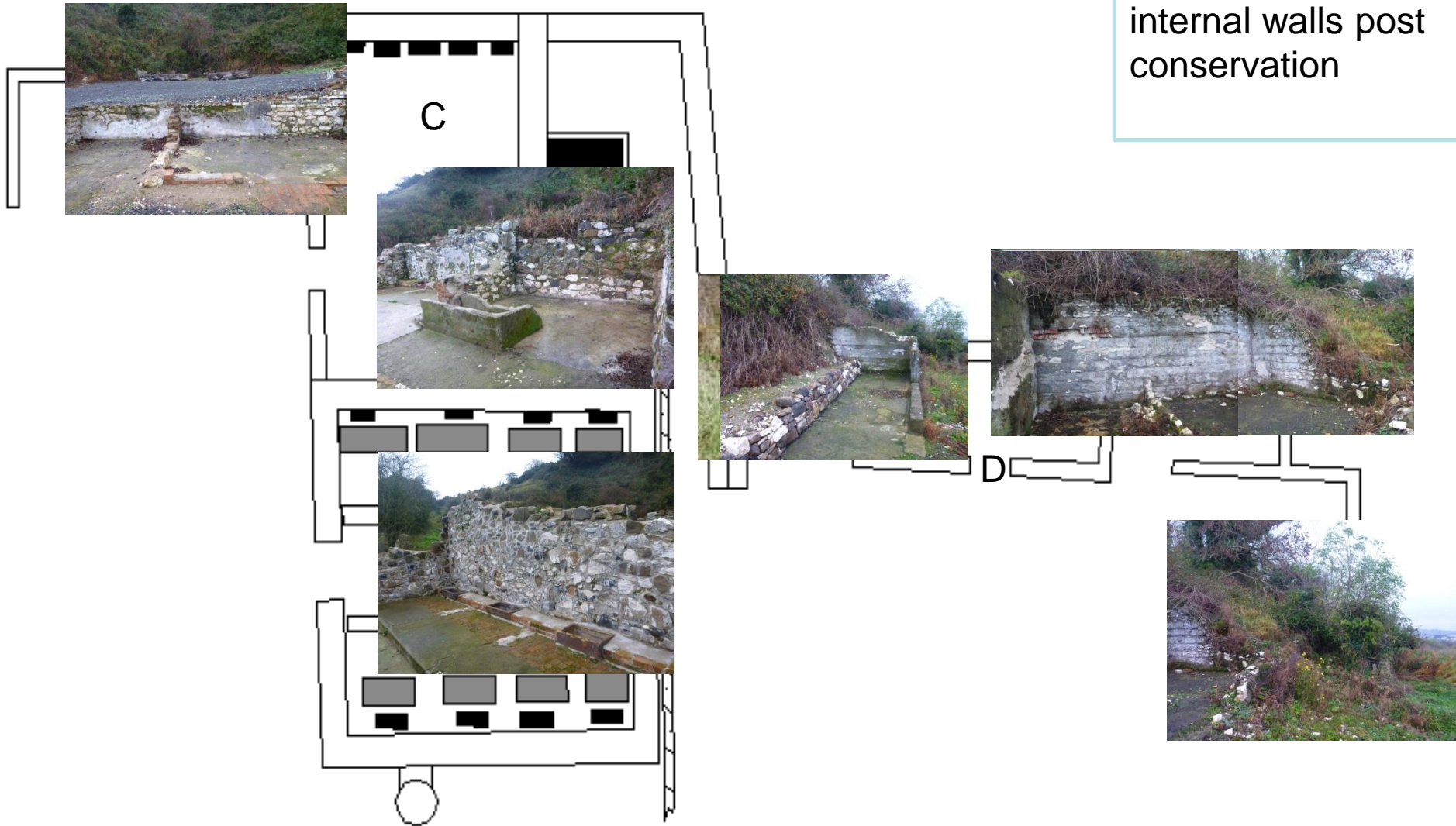

Updated November 2015
© Belfast Hills Partnership

Belfast Hills Partnership
9 Social Economy Village
Hannahstown Hill
Belfast
BT17 0XS

www.belfasthills.org

Tel: 028 9060 3466

E-mail: info@belfasthills.org