



**Survey Report: No. 3**  
**Photographic Survey of Corn**  
**Mill at Ligoniel, Belfast,**  
**County Antrim.**



**Site name:** Ligoniel dams

**Townland:** Legoniel

**Type of monument:** Corn Mill

**Grid Reference:** IGR J29477 77538

Photographic survey undertaken 1.7.2014 by Lizzy Pinkerton, Geoff Wright, Karen Foreman, Michael Catney, Geraldine Caldwell, Robert Sayers and Kate Todd.

**Site description:** The Corn mill is found by the Ligoniel Dams site part of the Belfast Hills which is owned and managed by Ligoniel Improvement Association. The Corn Mill is in ruinous state, largely obscured by trees and ivy. It is a basalt building with an 'L' shaped ground plan with no wall present today on the east facing elevation (see next page). Adjacent to the Corn Mill are two mill ponds, these are filled by a mill race which comes off the Forth River. This site was surveyed in 1989 for the Greater Belfast Industrial Archaeological Survey (GBIAS Nos 10309:1 and 1030:2) indicating its date of origin to be late 18<sup>th</sup> century. Adjacent to this site once stood the Wolfhill Flax Spinning Mill complex.

## Ligoniel Corn Mill wall footings plan

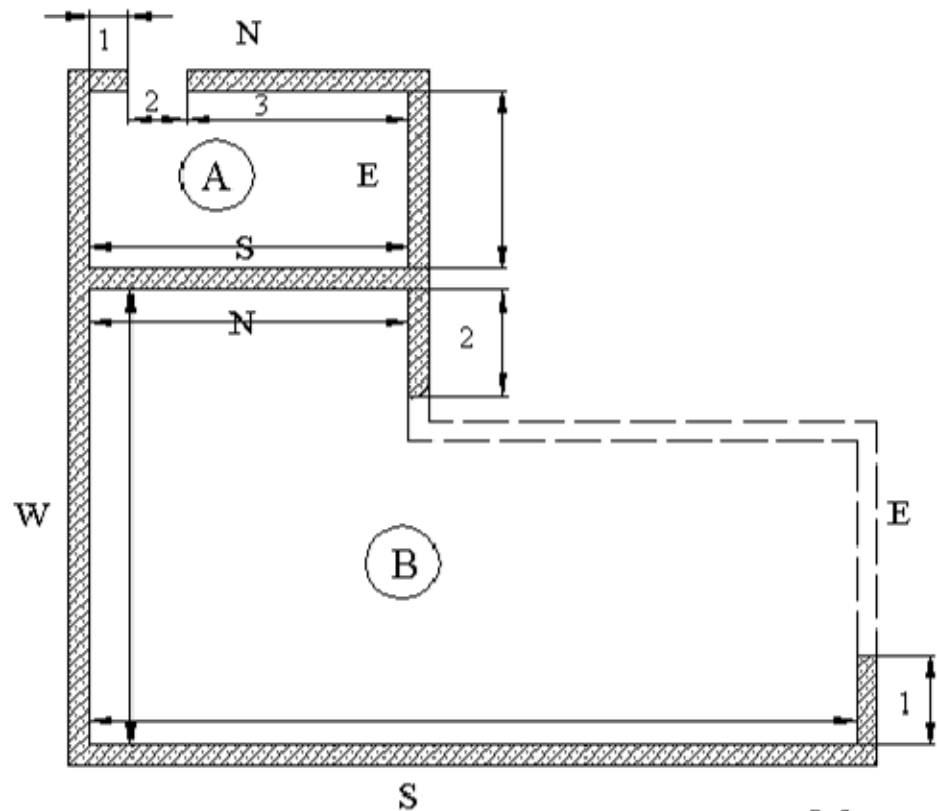

### Room A

N1 1,202m

N2 1.320m

N3 6.561m

S 9.083m

E 4.159m

### Room B

N 9,083m

S 16.425m

E1 2.016m

E2 2.940m

W 14.982m

Depth of Walls:- 650 to 690mm

Ligoniel Corn Mill

Measured by:- Robert Fitzpatrick-Sykes & Michael Catney

date:- 01 July 2014

From the floor plan it can be seen that the Corn Mill has two distinct sections – a large section to the south and much smaller northern section. In the smaller section the ‘doorway’ stretches over the two stories of the building, from this it could be speculated that this was not actually a doorway, but the location of the waterwheel.



Photographs of  
external walls

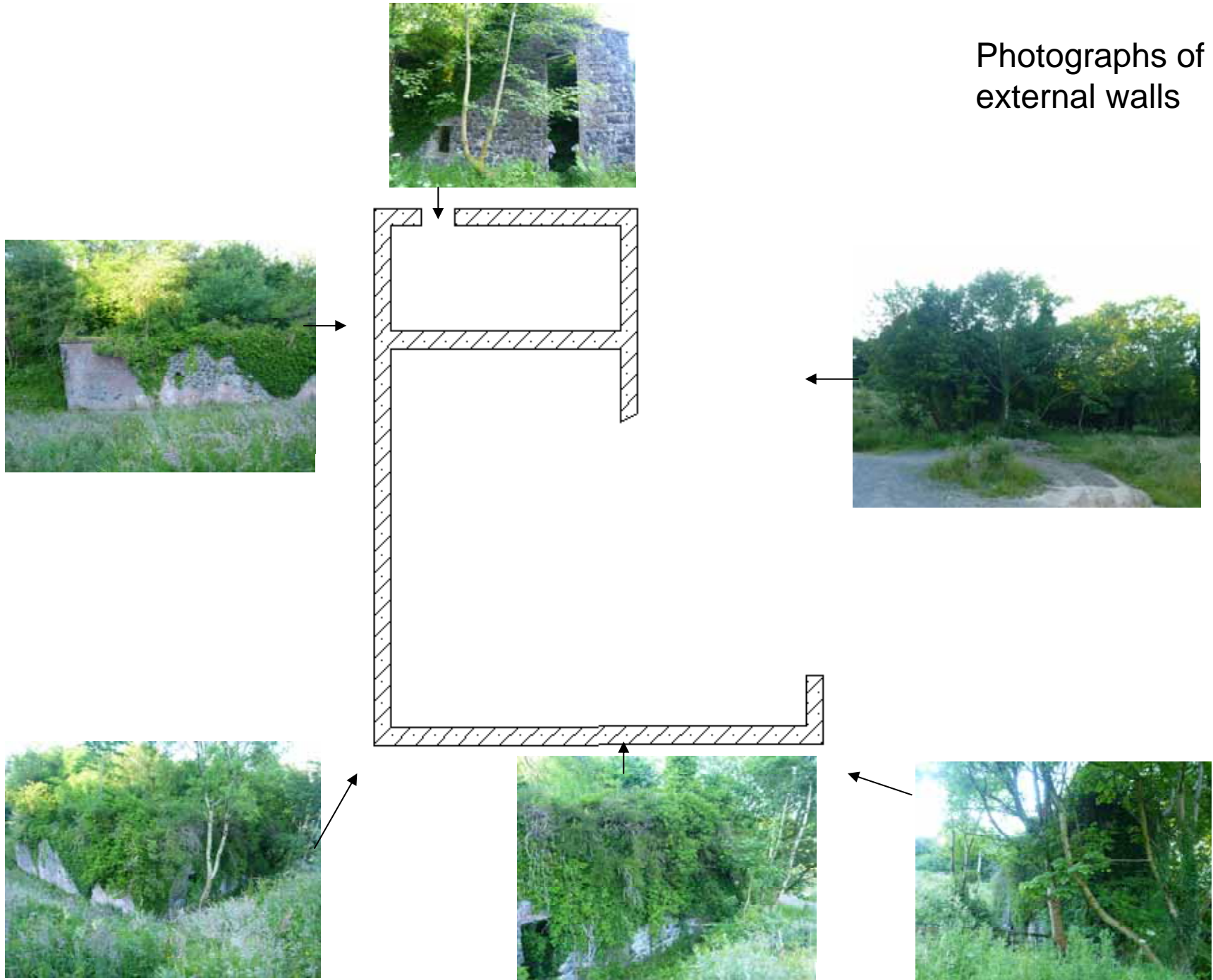



Photographs of  
external walls

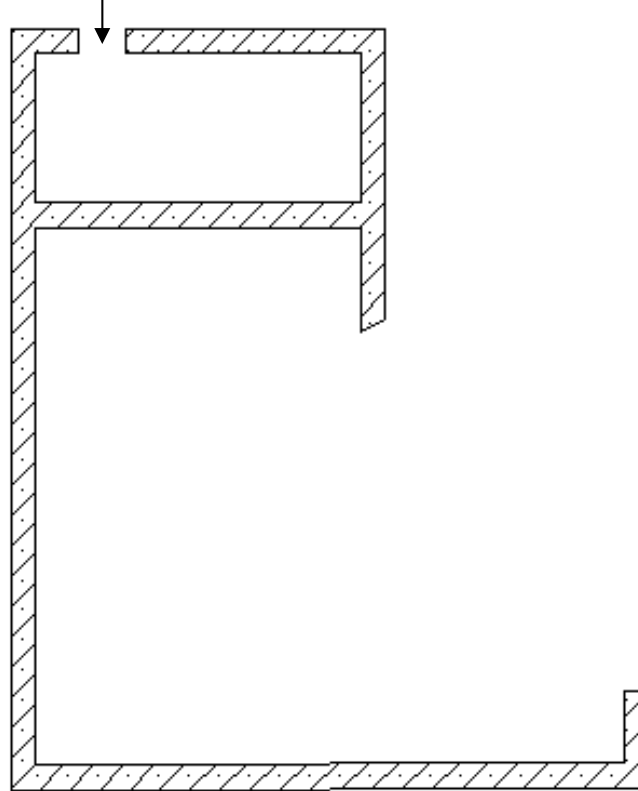







## Photographs of external walls

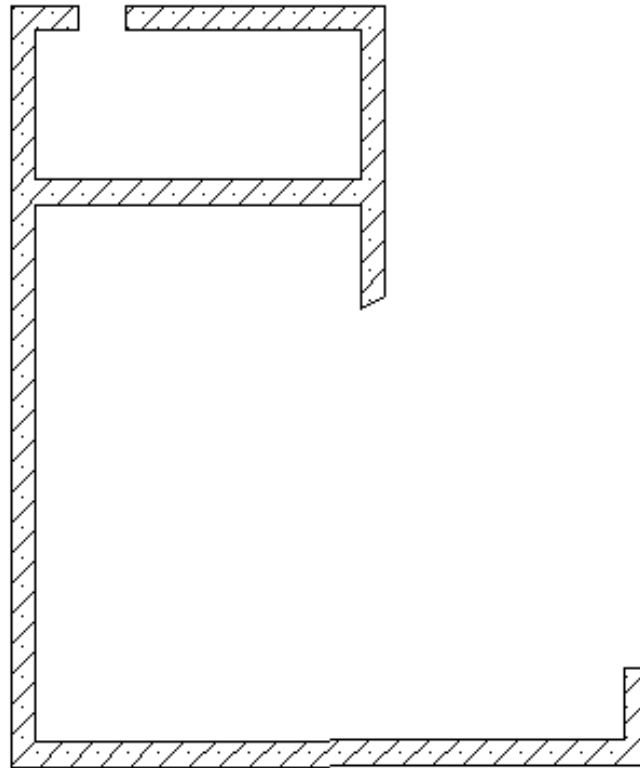







## Photographs of external walls

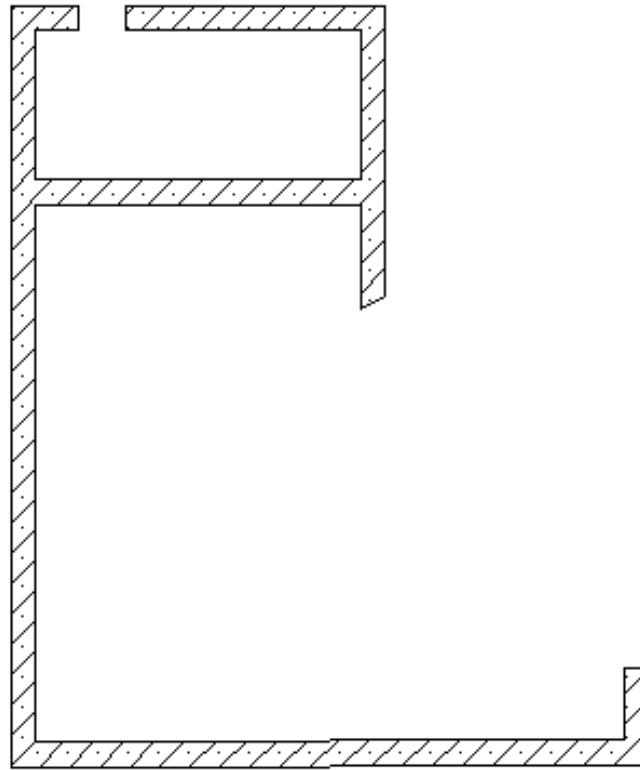







Photographs of  
external walls

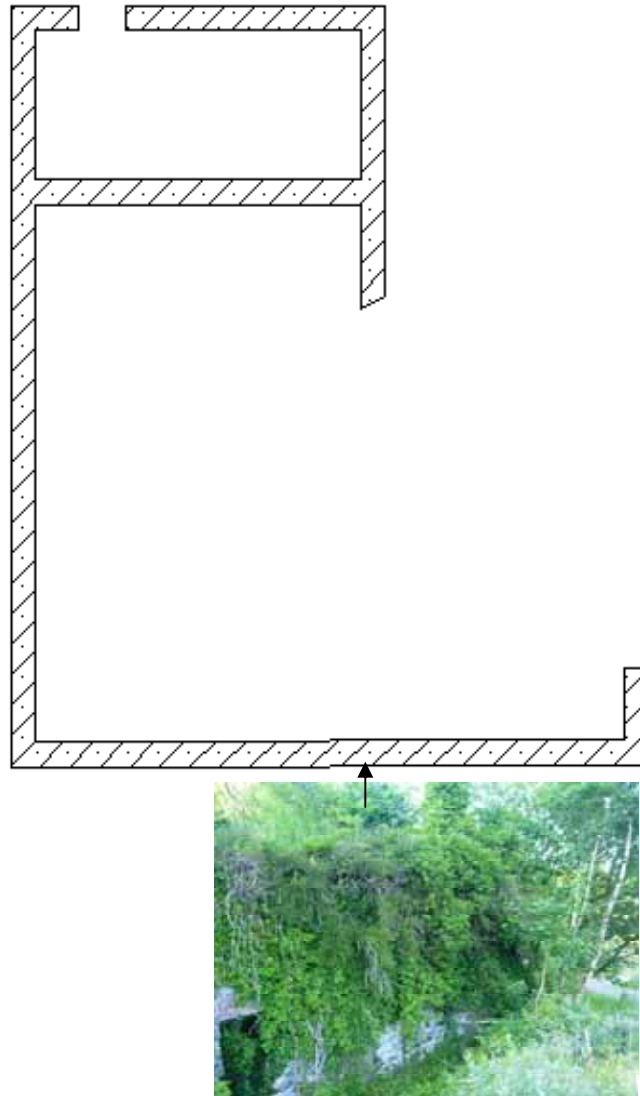







Photographs of  
external walls

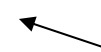
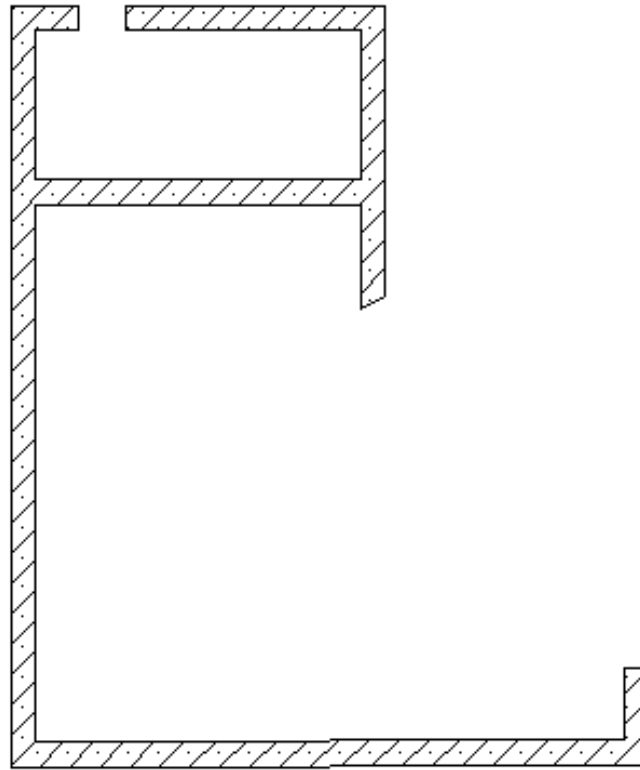







Photographs of  
external walls

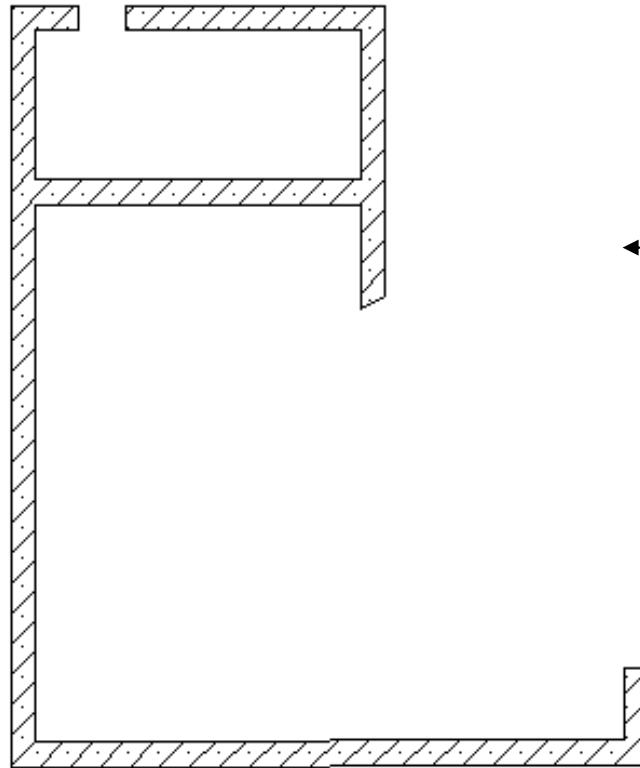





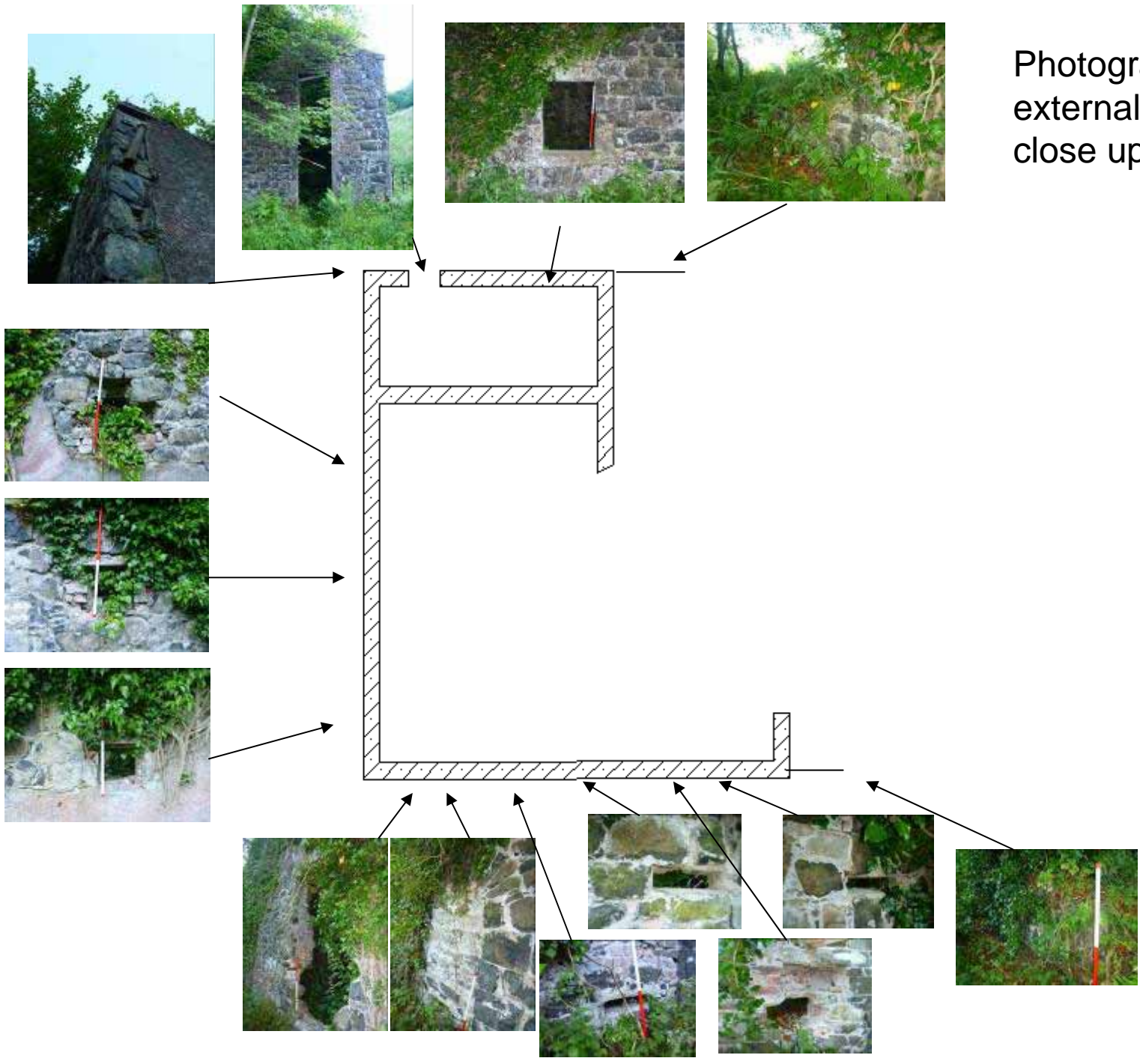

Photographs of external walls close up features

Photographs of  
internal walls –  
small room

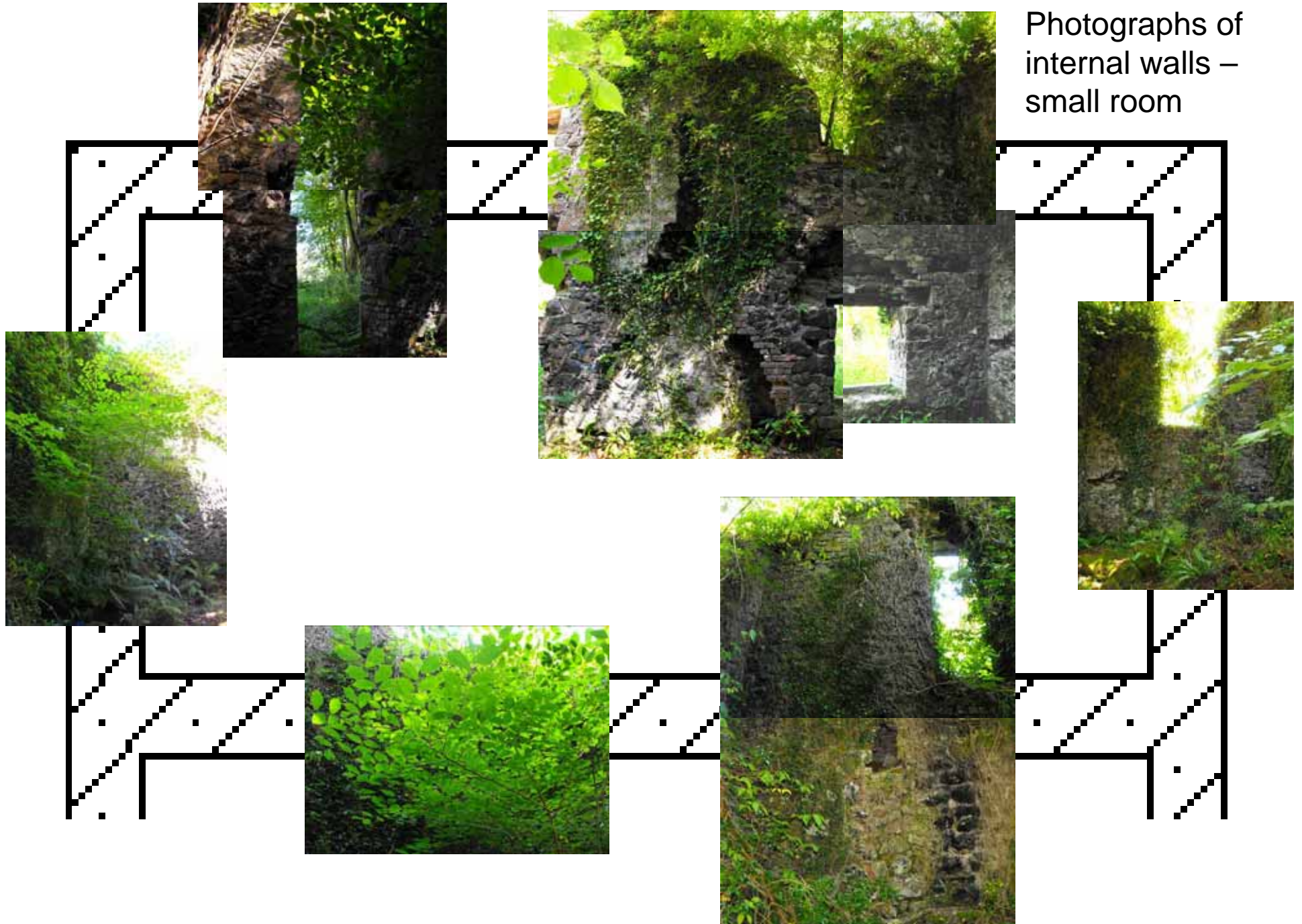





Photographs of  
internal walls –  
small room

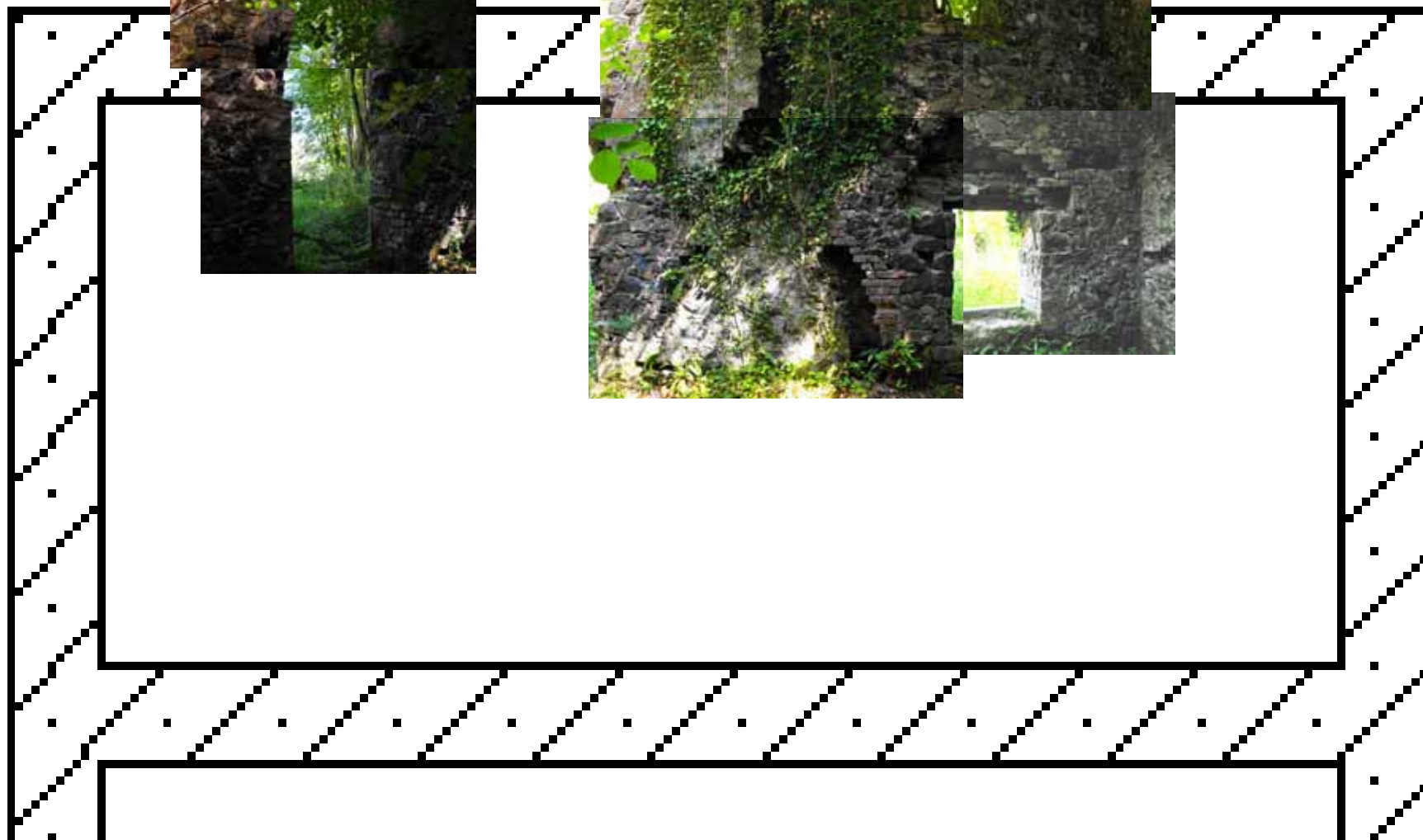







Photographs of  
internal walls –  
small room

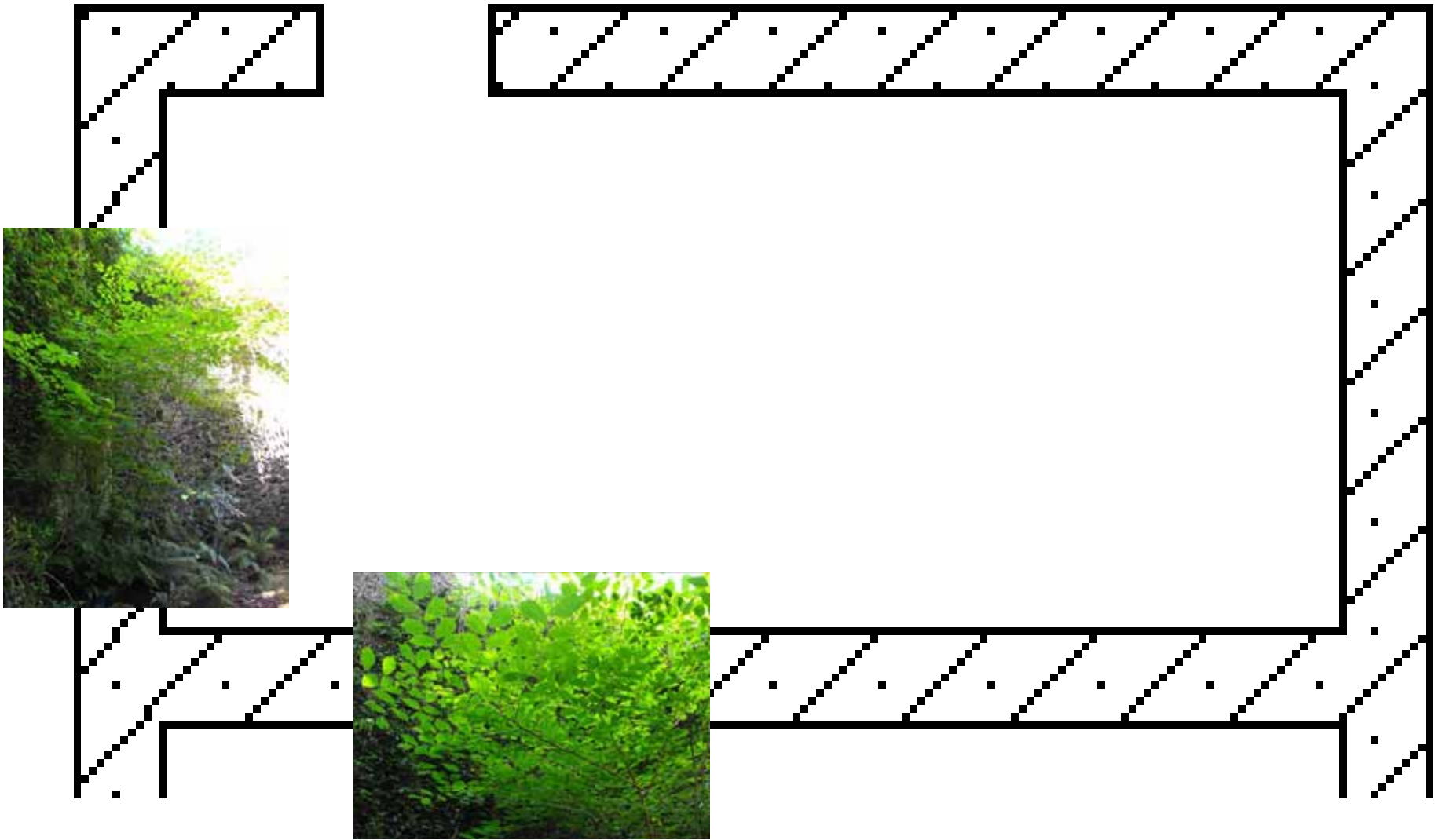





Photographs of  
internal walls –  
small room

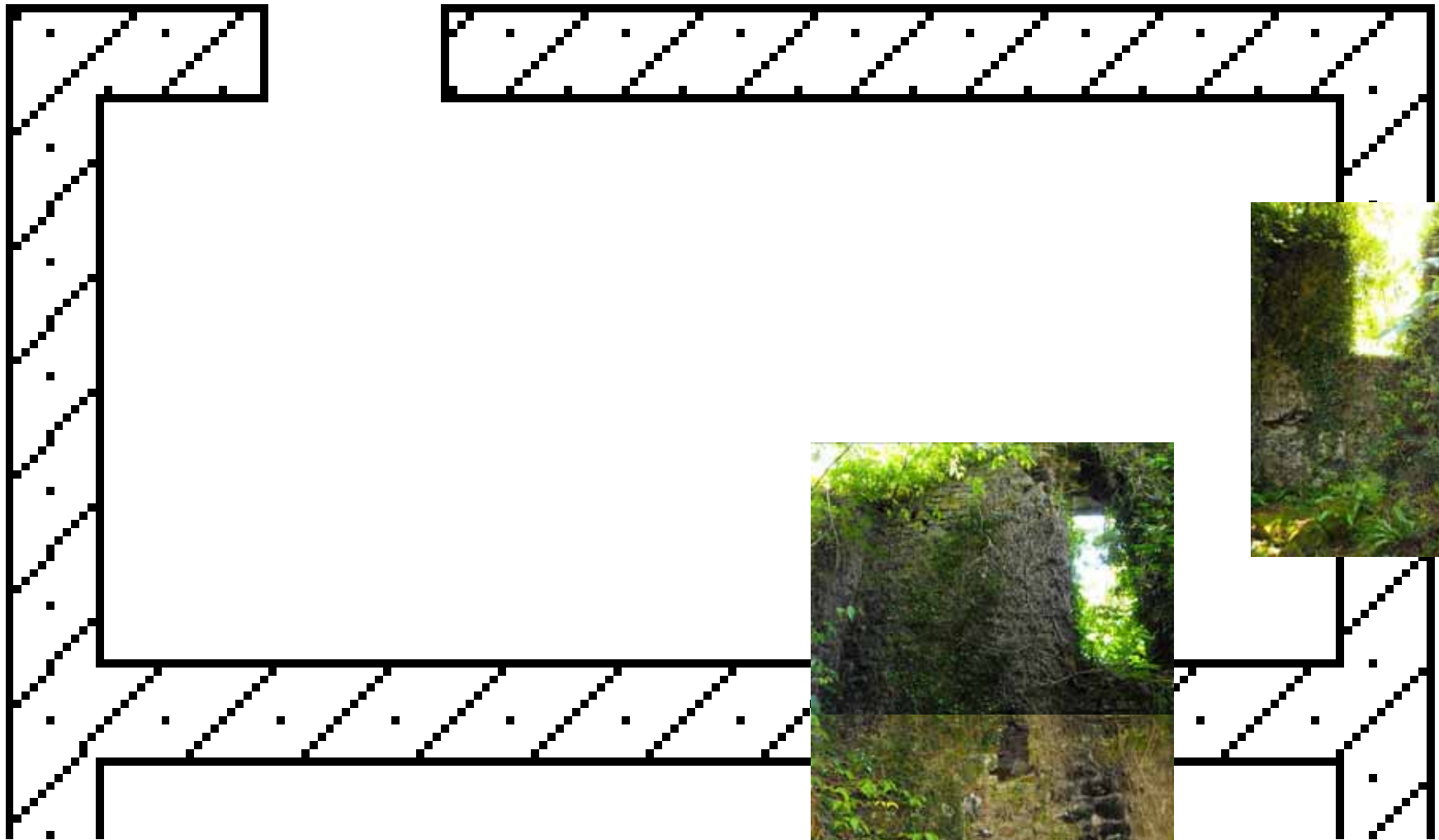







Photographs of  
internal walls –  
large room





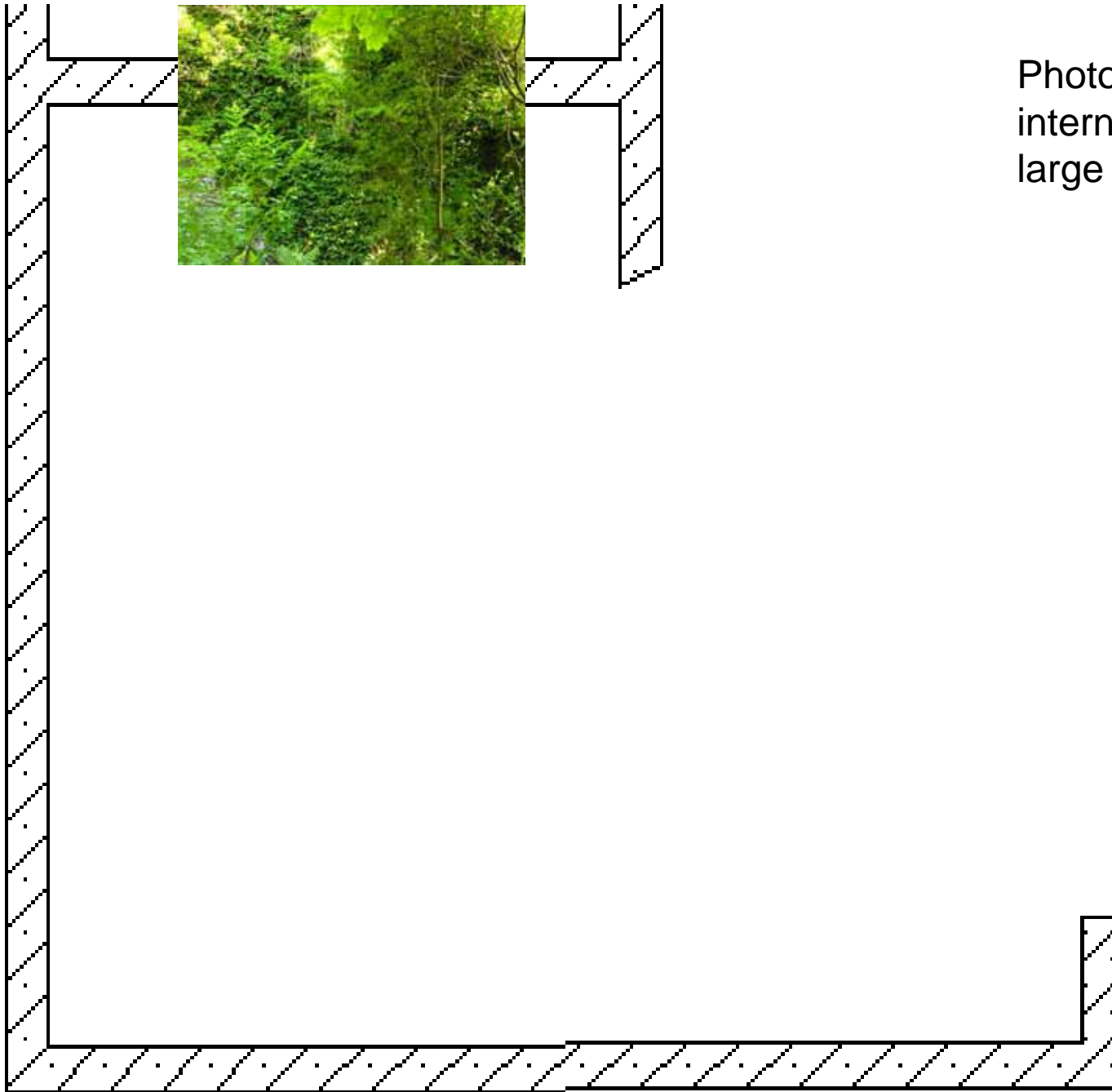

Photographs of  
internal walls –  
large room





Photographs of  
internal walls –  
large room







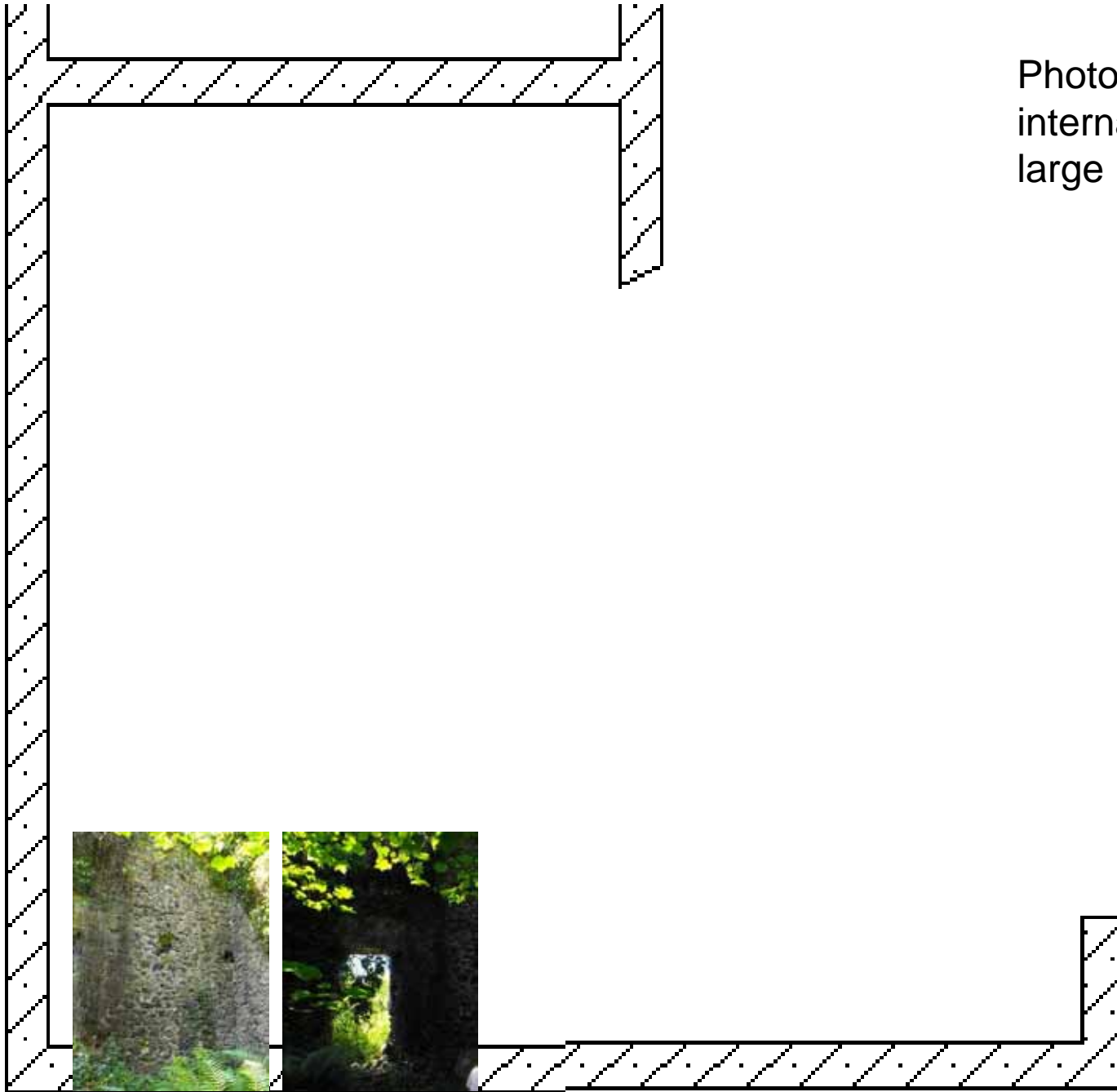

Photographs of  
internal walls –  
large room





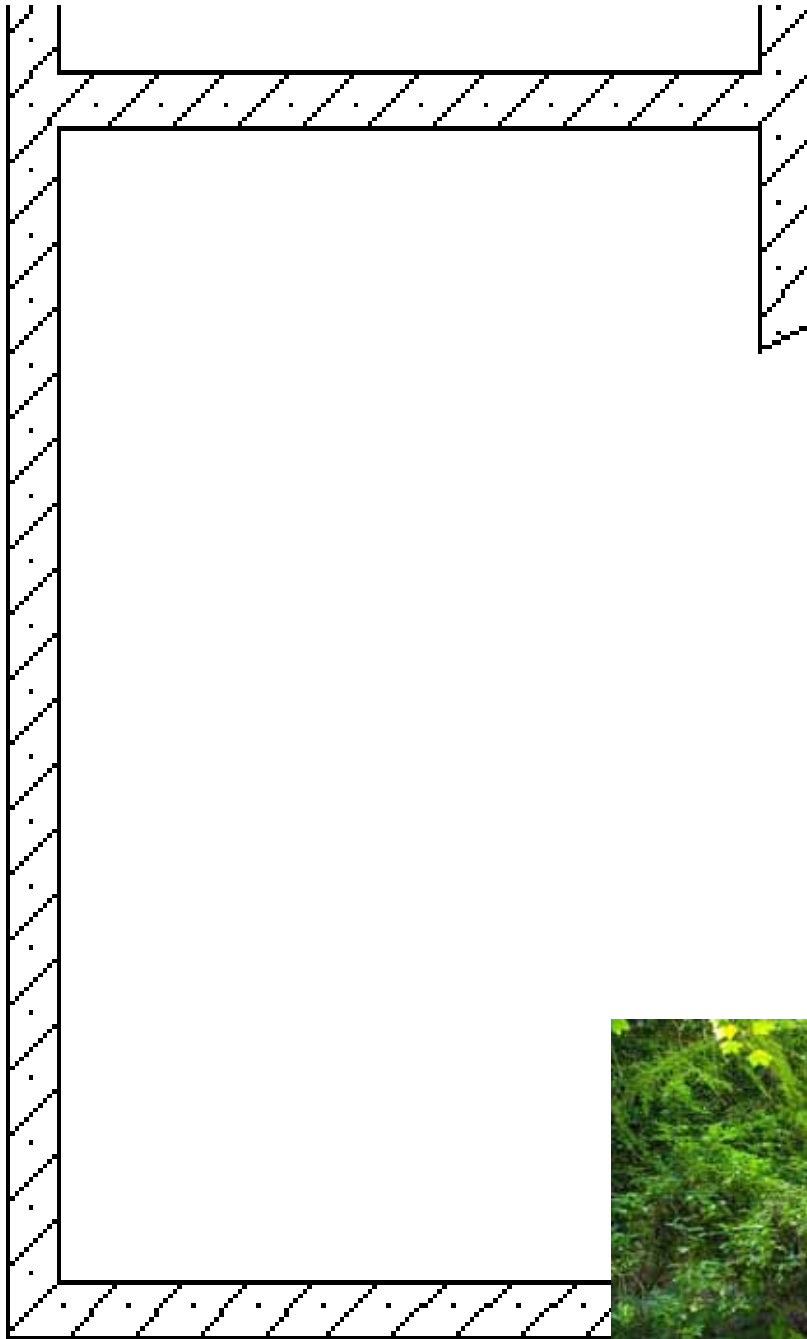

Photographs of  
internal walls –  
large room









First published July 2014  
© Belfast Hills Partnership

Belfast Hills Partnership  
9 Social Economy Village  
Hannahstown Hill  
Belfast  
BT17 0XS  
[www.belfasthills.org](http://www.belfasthills.org)  
Tel: 028 9060 3466  
E-mail: [info@belfasthills.org](mailto:info@belfasthills.org)